

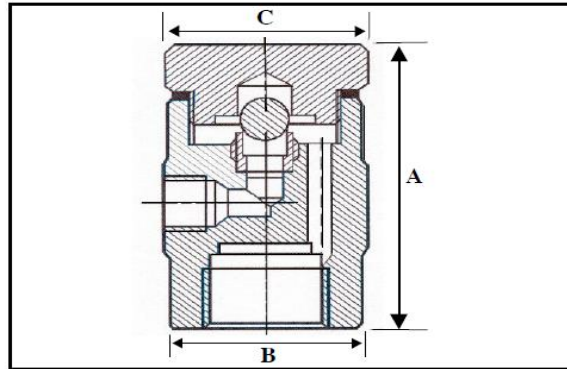

Stainless Steel Vacuum Breaker



DIMENSIONS				
Size (inch)	A	B	C	Weight
1/2"	55	34	39	0.35 kg

Operating Conditions:

Max.Allowable Pressure (PMA) **25 Bar**
 Max.Allowable Temperature (TMA) **400°C**

Sizes/Connections:

15mm
Screwed BSP/NPT

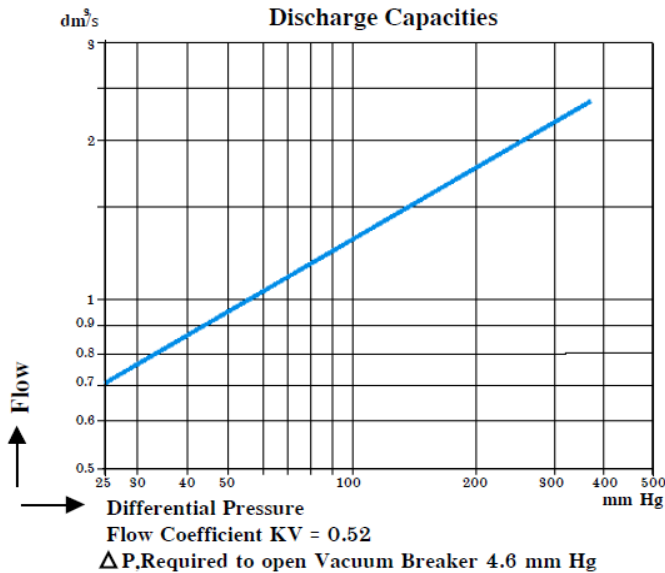

Typical Applications:

- Hydrophores
- Boiler Feeding Lines
- Boiler Pipes
- Container Feeding
- Discharging Lines

Installation:The vacuum breaker must be installed in a vertical position with the system connection at the bottom. On steam systems, the vacuum breaker should be installed at the highest point in the system where it will not be flooded with condensate.